

<b>Bike</b>	Triumph Tiger 900	<b>Part No.</b>	RTR-95
<b>Year</b>	2024 - Current	<b>Fit Kit</b>	Z039.10691
<b>Notes</b>	Where not supplied use original fittings. <b>REMOVE ORIGINAL GASKET</b> Fits with panniers	<b>dB Killer</b>	SCEXDBK24 (TYPE W)

Estimated Fitting Time: 60 Minutes

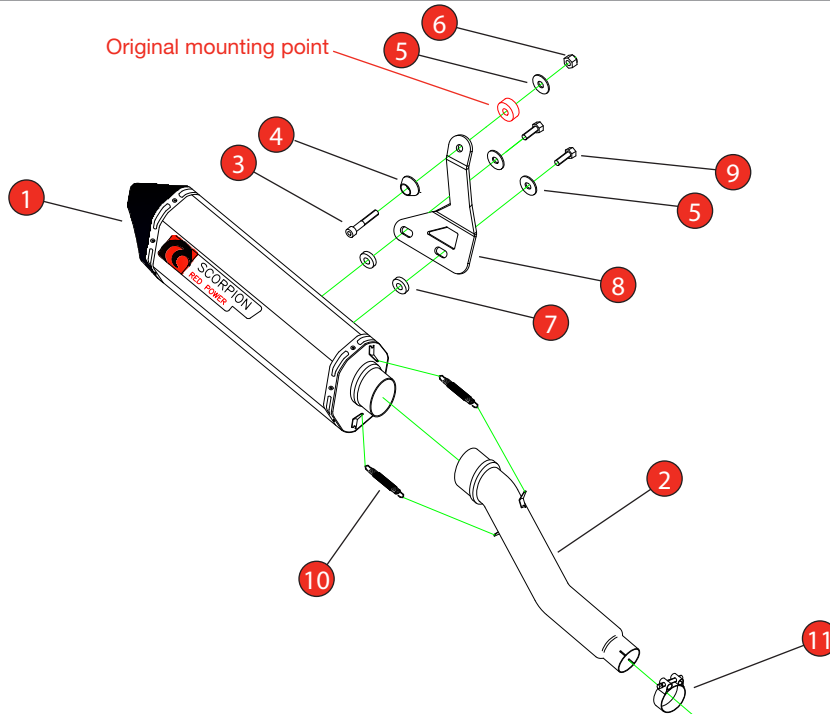

NO.	PART NO.	DESCRIPTION	QTY
1	RSC494	Serket Silencer	1
2	CP1193	Connecting Pipe	1
<b>Fit Kit - Z039.10691</b>			
3	Z017.10078	M8 x 50mm Cap Head Bolt	1
4	Z026.20068	Alloy Bolt Finisher	1
5	Z017.10825	M8 x 25mm Washer	3
6	Z017.10062	M8 Nyloc Nut	1
7	Z026.20049	M8 5mm Alloy spacer	2
8	Z015.31426	Mounting Bracket	1
9	Z017.10048	M8 x 25mm Hex Head Bolt	2
10	Z028.10030	Rubber Coated Spring	2
11	Z016.10008	43-47mm Clamp	1

CLASSIFICATION	Closed Circuit Product
HOMOLOGATED	No
DATE	18/04/2024
ISSUE	00
AUTHORISED	G. O'Shea

**NOTE:** ENSURE SCORPION SYSTEM IS CLEAR OF MOVING PARTS AND ALL ORIGINAL FUNCTIONS WORK CORRECTLY.

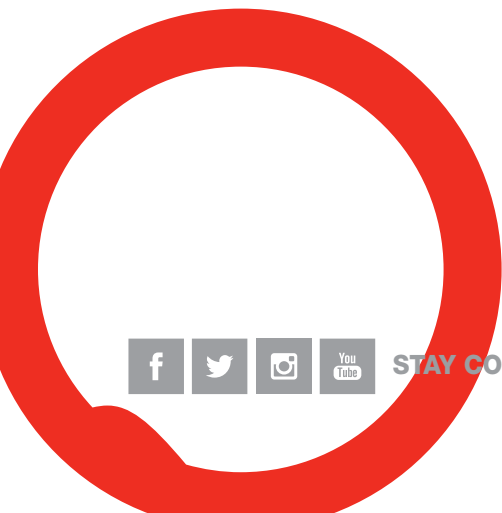

STAY CONNECTED TO RED POWER.

Bike	Triumph Tiger 900	Part No.	RTR-95
Year	2024 - Current	Fit Kits	Z039.10691
Notes	Where not supplied use original fittings. <b>REMOVE ORIGINAL GASKET</b> Fits with panniers	dB Killer	SCEXDBK24 (TYPE W)

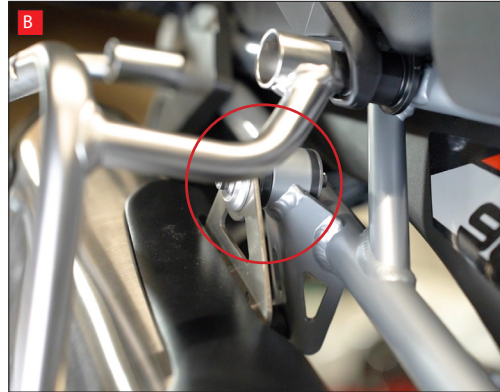

A) Start by loosening the clamp on the original exhaust.

B) Loosen the bolt for the original silencer mounting bracket and remove the nut from the back.

C) Support the weight of the silencer, then remove the mounting bolt.

D) Carefully remove the silencer from the bike.



E) Slide the supplied clamp over the the end of the Scorpion connecting pipe.

F) Slide the connecting pipe over the original exhaust.

G) Place the Scorpion silencer face down on a soft, clean surface.

H) Place the supplied spacers over the bolt hole on the top of the silencer.





Bike	Triumph Tiger 900	Part No.	RTR-95
Year	2024 - Current	Fit Kits	Z039.10691
Notes	Where not supplied use original fittings. <b>REMOVE ORIGINAL GASKET</b> Fits with panniers	dB Killer	SCEXDBK24 (TYPE W)



I) Place the bracket over the spacers and align roughly with the centre of the slots.

J) Attach the bracket to the silencer using the supplied washers and bolts. Leave slightly loose for now, you will fully tighten these in a later stage.

K) Slide the silencer onto the connecting pipe and align the bracket with the original mounting on the bike. If you have panniers be careful not to mark the silencer on the pannier frame.

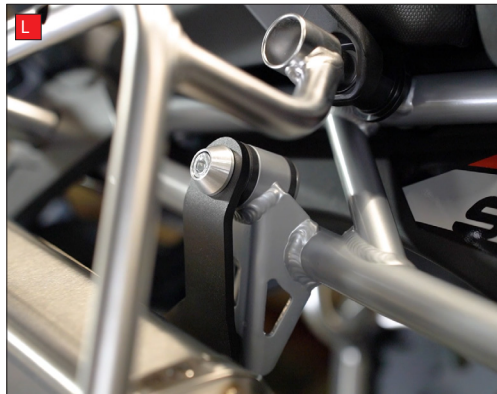

L) Secure the silencer in place with the supplied mounting hardware. Leave a little loose for now, you will fully tighten at a later stage.

M) Attach the springs between the silencer and the connecting pipe.

N) Adjust the system so that it fits nicely, under no tension and is away from the pannier frame if fitted. Then fully tighten the clamp between the Scorpion connecting pipe and the original exhaust.



O) Fully tighten the 2 bolts on the rear of the silencer.

P) Fully tighten the silencer mounting bolt.

Take the bike for a short ride to ensure all functions are correct. When the bike & exhaust are cool enough check all nuts and bolts are still secure.



<b>Bike</b>	Triumph Tiger 900	<b>Part No.</b>	RTR-95
<b>Year</b>	2024 - Current	<b>Fit Kit</b>	Z039.10691
<b>Notes</b>	Where not supplied use original fittings. <b>REMOVE ORIGINAL GASKET</b> Fits with panniers	<b>dB Killer</b>	SCEXDBK24 (TYPE W)

Estimated Fitting Time: 60 Minutes



Thank you for purchasing your Scorpion Silencer.

Care of your exhaust: Please refrain from cleaning silencer with heavy solvents or abrasives!

Vielen Dank Für den kauf eines Scorpion Schalldampfers! Pflegehinweis: Bitte verwenden Sie niemals Scheuermittel oder aggressive Reiniger zur Pflege Ihres Auspuffes!

Merci d'avoir choisi un echappement Scorpion.

Entretien de votre silencieux: Ne pas utiliser de solvants ou de produits abrasifs!

Muchas gracias por adquirir un Silencioso Scorpion. Le recomendamos no limpiar el silencioso con productos abrasivos o aquellos que contengan disolventes.



STAY CONNECTED TO RED POWER.